

MPK SERIES PUSH-IN TYPE MINI EARTH TERMINAL BLOCKS MPK SERİSİ YAY BASKILI MİNİ RAY KLEMENSLER

PUSH IN



MPK - 2,5 (Earth)

Closed Type

Order No: 1470

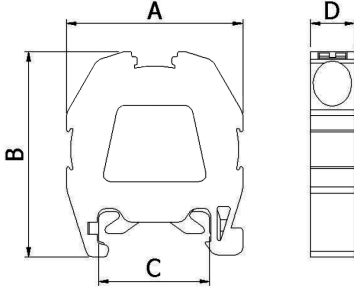
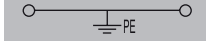

Dimensions Ölçüler (mm)	A	B	C	D
	23,0	26,5	15,0	5,9

MATERIAL / MATERYAL

Body / Gövde	PA6.6 V2
Bridge / Köprü	Copper / Bakır
Orange Button Turuncu Buton	PA6.6 V2
Spring/ Yay	Stainless Steel / Paslanmaz Çelik
The Foot Which Contact to the Rail/ Raya Temas eden Ayak	Brass / Pirinç
Temp./ Sıcaklık	-40 °C, +140 °C
Cable Strip L. / Soyma Boyu	8 mm

DATA / VERİ	TSE / CE
Voltage / Gerilim	750 V
Section / Kesit	2,5 mm ²
Norm	EN-60947-7-1

ACCESSORIES / AKSESUARLAR

Stopper / Durdurucu	1472
Marking / Markalama	9540
Rail / Ray	4247, 4252, 4102, 4112